

DIN 1587
Sechskant-Hutmuttern,
hohe Form

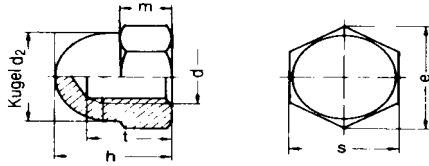

d mm	h	d2 mm	t	s	e min	m
M 3	6	4,8	3,5	5,5	6,08	2,8
M 4	8	6,5	5,5	7	7,74	3,2
M 5	10	7,5	7,5	8	8,87	4,0
M 6	12	9,5	8,0	10	11,05	5,0
M 8	15	12,5	11,0	13	14,38	6,5
M 10	18	16,0	13,0	17	18,90	8,0
M 12	22	18,0	16,0	19	21,10	10,0
M 14	25	21,0	18,0	22	24,49	11,0
M 16	28	23,0	21,0	24	26,75	13,0
M 20	34	28,0	26,0	30	33,53	16,0
M 24	42	34,0	31,0	36	39,98	19,0

alle Angaben ohne Gewähr – noch Fragen? techdat@wegertseder.com